

# PRINTING OPTIONS



## 4 different ways of printing on Tape

Tape can be printed in various ways.  
The 4 different options are explained below.

### **Positive printing:**

The majority of the tape is unprinted. The colour of the tape determines the surface colour. This method of printing is used the most.  
The under colour is then often white, so that the printing is clearly visible.

The three standard tape colours are: White, brown and transparent

For PVC tape, it is also possible to print on coloured tape. Coloured tape is available in the colours yellow, red, green, blue orange, fluorescent orange, black and white/white.

*Positive printing on white tape,  
2 colours: Orange PMS 021 and Blue PMS 279c*

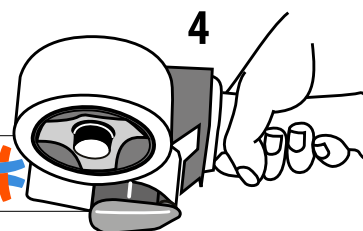

*Positive printing on brown tape,  
2 colours: Orange PMS 021 and Blue PMS 279c*

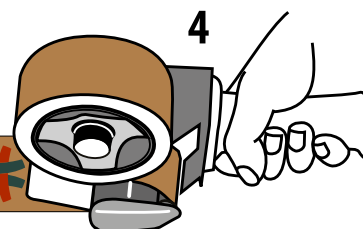

*Positive printing on yellow tape (without weld seam),  
1 colour: Black*

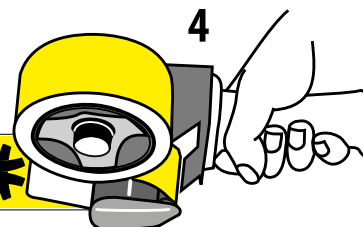

# PRINTING OPTIONS

## **Diapositive printing:**

With this type, the letters and/or logo are preserved and printed in a coloured or black background. On white tape, the letters are then white (tape colour) and the background coloured or black (ink colour).

The plate seam (weld seam) is visible here: this is created by repeating the plate. This is because the flat plate is placed around a cylinder. This creates a V-shape where the ends come together. The weld seam is the vertical unprinted white line that you see in the example

*Diapositive printing on white tape (with weld seam),  
2 colours: Orange PMS 021 and Blue PMS 279c*



Note: With a diapositive printing on PVC tape, the background colour is not printed to the edge of the tape, but approx. 1.5 mm from the edge. This is done to ensure that no ink gets on the bottom of the tape, which can cause the tape to tear sooner. Full-bleed printing is possible, but that invalidates the warranty.

## **Coloured printing:**

With this, the entire tape is first coloured with the desired background colour and the image is printed over it.

In this way, there is no chance of a weld seam because there is no interruption in the printing plate when colouring.

*Coloured printing on white tape (without weld seam),  
2 colours: Black and Blue PMS 279c*



Note: With a diapositive printing on PVC tape, the background colour is not printed to the edge of the tape, but approx. 1.5 mm from the edge. This is done to ensure that no ink gets on the bottom of the tape, which can cause the tape to tear sooner. Full-bleed printing is possible, but that invalidates the warranty.

# PRINTING OPTIONS

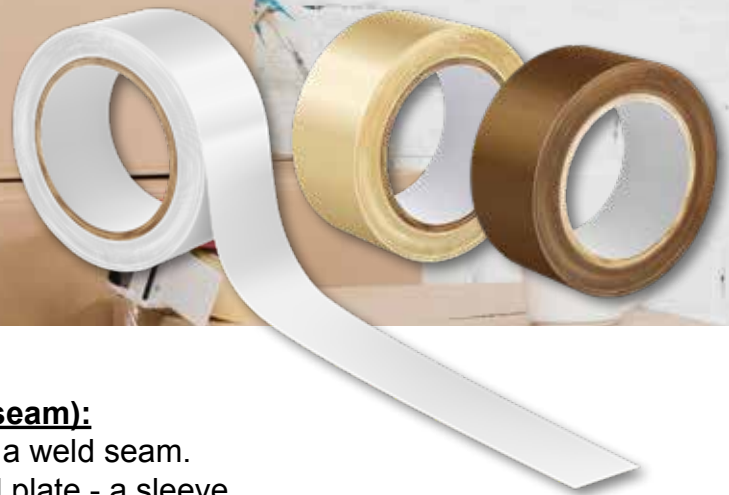

## **Diapositive printing with sleeve (without weld seam):**

This is the same as a diapositive print, but without a weld seam.

This is made possible by using a completely round plate - a sleeve.

Advantage: no weld seam.

Disadvantage: higher plate costs.

*Diapositive printing with sleeve on white tape (without weld seam),  
2 colours: Orange PMS 021 and Blue PMS 279c*

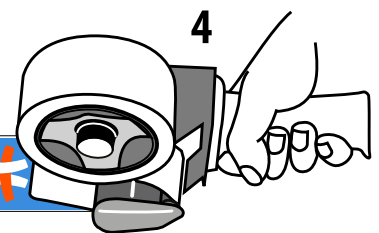

*Note: With a sleeve printing on PVC tape, the background colour is not printed to the edge of the tape, but approx. 1.5 mm from the edge. This is done to ensure that no ink gets on the bottom of the tape, which can cause the tape to tear sooner. Full-bleed printing is possible, but that invalidates the warranty.*